

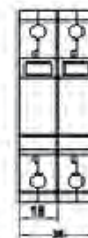

Single Phase (2MOV Module) Surge Protective Devices **D1-40/275-2MV-R** **(D1-50/275-2MV-R)**

Surge arrester for low-voltage power supply system protection against surges at the boundaries from lightning protection zone 0B-1 and higher.

- Class II (C) arrester in according with IEC61643-11.
- Two part design consisting of base and plug-in modu
- High energy MOV (Metal Oxide Varistor) inside.
- Reliable supervision due to disconnection device.
- Fault indication by red indication flag in window.
- Fast response.
- With remote alarm terminal.

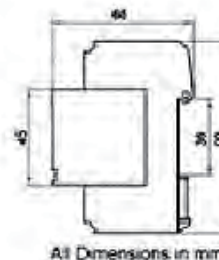
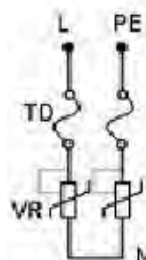

Technical Data

Type	D1-40/275-2MV-R		D1-50/275-2MV-R	
	275			
In accordance with	IEC61643-11		UL1449 3rd	
Category IEC/VDE	Class II/C		Type 1 & 2	
Max. continuous operating voltage (AC/DC)	275/300			
Nominal discharge current(8/20) In	L-N	20KA	20KA	
	N-PE	20KA	20KA	
Max. discharge current(8/20) Imax	L-N	40KA	50KA	
	N-PE	40KA	50KA	
Voltage protection level @In	1.3KV		/	
Voltage protection rating @6KV/3KA	/		1.0KV	
Response time	≤25 ns			
Backup fuse(only required if not already provided in mains)	125A gL/gG			
Operating temperature range	- 40°C ~ + 80°C			
Cross-section of connection wire	Single-strand 35mm ² ; multi-strand 25mm ²			
Mounting	35mm DIN-rail in accordance with EN 50022/DIN46277-3			
Enclosure material	thermoplastic; extinguishing degree UL94 V-0			
Degree of protection	IP20			
Installation width	2 modules, DIN 43880			
Thermal disconnecter	Internal green – normal red - failure			
Remote alarm contact	Yes			
Additional data for Remote Alarm Contacts				
Remote alarm contact type	floating changeover contact			
Switching capability UN/IN	AC: 250V/0.5A DC: 250V/0.1A; 125V/0.2A; 75V/0.5A			
Cross-section of connection wire	Max. 1.5mm ²			

note: subject to change without any notice, JDA pay no responsibility